

# My Excursion to Bunbury Museum and Heritage Centre

BUNBURY  
MUSEUM  
+ HERITAGE  
CENTRE



A Visual Story

# Contents

|   |    |
|---|----|
| Where I am going                          | 3  |
| Excursions                                | 4  |
| The right things to do at the Museum      | 5  |
| Where can I go if I need somewhere quiet? | 6  |
| Finding the Museum                        | 7  |
| Entering the Museum                       | 8  |
| Putting down your bag                     | 9  |
| Inside the Museum                         | 10 |
| Toilets                                   | 11 |
| Museum front desk                         | 12 |
| What to do in the Museum                  | 13 |
| Walking around the Museum                 | 14 |
| The classroom experience                  | 16 |
| Leaving the Museum                        | 17 |

# Where I am going



I will use this Visual Story to prepare for my visit to Bunbury Museum and Heritage Centre. The Museum holds objects and images which tell stories about the people and places of Bunbury over time.

The Museum is open from 10:00am to 4:00pm every day except for Mondays.

# Excursions



Excursions happen when school students come to the Museum with their class and teachers.

Most classes arrive at their excursions on a bus.

# The right things to do at the Museum

Here are some of the things we need to do at the Museum to keep our visitors and our objects safe.



I will walk inside the Museum so that I do not fall over or bump into people or things.



I will not take food or drinks into the Museum so that nothing is spilled inside.



I will keep objects safe by not touching them unless there is a 'Please touch' sign.



I will keep my hands clean before and after I touch things. I can use the hand sanitiser by the front door or wash my hands in the toilets.

# Finding the Museum



The Museum is located on Arthur Street. It is outside of Centrepoint shopping centre. The front door is on the Arthur Street side. There are car parks next to the Museum.

# Entering the Museum



The front door of the Museum is automatic. It will open as you walk toward it.

# Entering the Museum



Lights on the floor show a welcome message when you walk inside.



The Visitors Centre is in the same building as the Museum. A staff member will welcome you into the Museum.



# Putting down your bag



You can leave your bag in the back office of the Museum.

It will be safe there, where Museum staff can see it while you enjoy your excursion.

# Inside the Museum

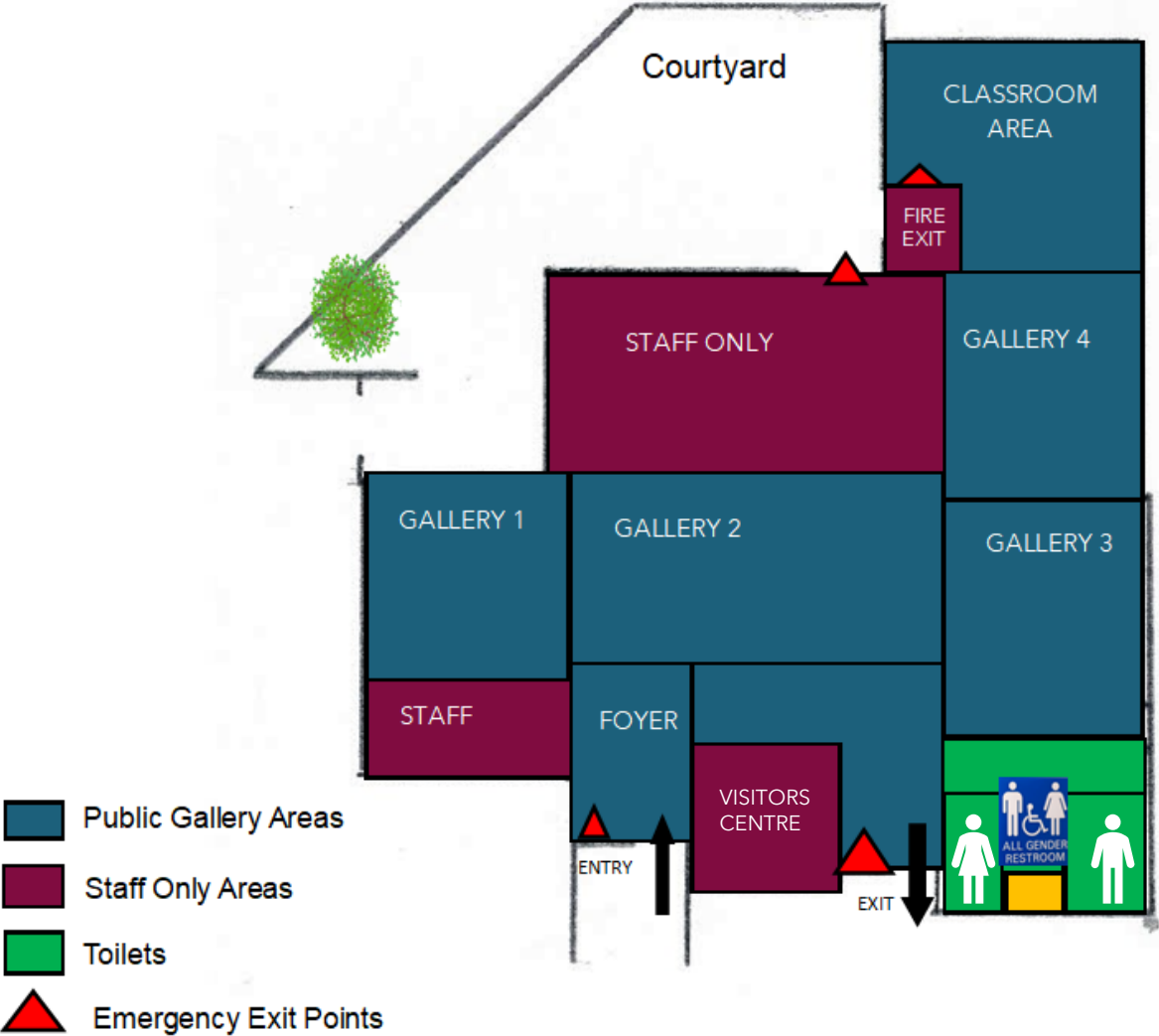

This is where everything is inside the Museum.

# Toilets



The toilets are straight ahead as you walk in front of the front desk from the front door. If you are not sure where to find them, ask the person at the front desk.

# Museum front desk



This is where a Museum staff member will sit. You can ask this person questions about the Museum. Sometimes, staff will be helping with your excursion, and they will not be behind the front desk.

# What to do in the Museum

While you are at the Museum, this is what you can do.



I can look at objects and pictures from the past.



I can read information about the history of Bunbury on panels around the Museum.



I can think about what I have learned and ask questions if I want to.



I can sit down and rest or complete an activity in the classroom.

# Walking around the Museum



For part of your excursion, a staff member will take your class on a tour of the Museum. They will tell you stories about some of the objects you can see.

# Walking around the Museum



Some of the displays in the museum stay the same for a long time. The gallery in front of the classroom changes often so that there are new things to look at.

# The classroom experience



The Museum building used to be a school. The classroom has been set up to show what it might have looked like when the building was still a school.

A staff member will give you activities to do which show what school was like a long time ago.



# Leaving the Museum



The exit door is on the other side of the front desk. It is automatic and it will open when you walk toward it.

**We hope you enjoy  
your excursion to  
Bunbury Museum and  
Heritage Centre!**

**BUNBURY  
MUSEUM  
+ HERITAGE  
CENTRE**

